

Cooler Brightz™

Instructions

©Copyright Brightz, Ltd. 2015

Patent Pending

All rights reserved

Step 1 – Install batteries

From the BACK of the battery holder slide the back up to remove the battery cover. Install 3 fresh AA batteries, observing the correct polarity (+/-). Replace battery cover. *Do not mix old and new batteries and do not mix alkaline, standard (carbon-zinc) or rechargeable (ni-cad, ni-mh, etc.) batteries.*

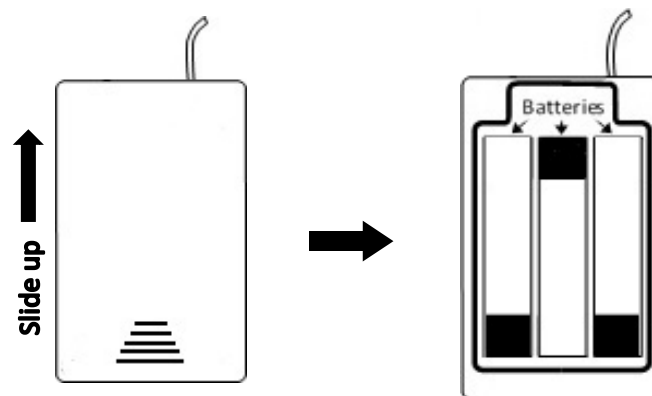

Step 2 – Operation

To operate, from the front of the battery pack slide the LED switch to the "on" or "off" position. **NOTE: Lights are waterproof but battery pack is not.**



Step 3 – Adding the LED lights

Lights look best and provide an *awesome glow* when placed underneath ice.

This method is easiest:

1. Add layer of ice to fill the bottom half of cooler.
2. Position LED string on top of ice.
3. Attach battery pack to the **outside back** of the cooler using the provided hook/loop mounting attachments.
4. **Do not put battery pack inside cooler! The battery pack is not waterproof!**
5. Add bottles and/or cans.
6. Add remaining ice.
7. Stand back and admire your work!

Cooler Brightz™ is available in 6 colors: Blue, Green, Red, Gold, Orange, and White

Mix and Match for your next party or team event!



Cooler Brightz™ are not for use in drink dispensing coolers or any beverage dispensing system.



Do not place battery back inside cooler. Only attach battery pack to the outside of cooler.



Do not place Cooler Brightz™ inside drinks.



Not a toy.

Brightz, Ltd.

8000 Yankee Road, Suite 225, Ottawa Lake, MI 49267

Email: info@brightz-ltd.com

www.brightz-ltd.com